

ModulArt In-plant Office

“From Structure To Solution — With Precision And Speed”



MEPL Factory @ Kopar Khairne, Navi Mumbai

ABOUT US

Manik Engineering Pvt. Ltd., a leading manufacturer since 1973. We supply high-quality products for the Industrial, Warehouse and Office Sectors. Our modern 35,000 sq. ft. facility in Navi Mumbai is equipped with advanced technology, and we are committed to excellence and customer satisfaction.

LEADERSHIP

Mr. Kishin Manik, our Managing Director, brings 50 years of unmatched expertise to Manik Engineering Pvt. Ltd. His visionary leadership, blending traditional methods with cutting-edge advancements, has been key to the company's growth and success.

AWARDS AND ACCOLADES



2 Star Export House
Certified by Gov Of India



ISO 9000:2015
Certified



Patented
Technologies

MISSION

Our mission is to leverage our decades of experience and expertise to design, manufacture, and deliver top-notch products that exceed customer expectations in terms of quality, reliability, and performance.

VISION

Our vision is to be a globally recognized and respected leader in manufacturing high-quality interior products for the Industrial Warehouse and Office Sectors.

QUALITY POLICY

“Committed to Consistent Excellence, Precision, Sustainability, and Customer Satisfaction.”

“OUR TECHNOLOGY MAKES IT EASY TO ...

**RELOCATE
CONFIGURE
PAIR**

... ANY TIME.”

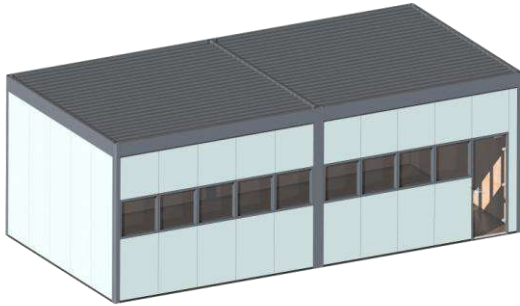

SINGLE STOREY IN-PLANT OFFICE

**SINGLE STOREY IN-PLANT OFFICE
with MEZZ. STORAGE**

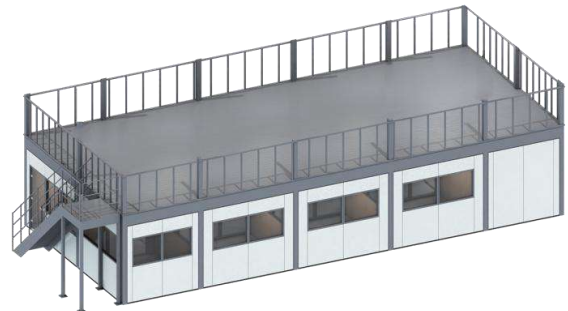

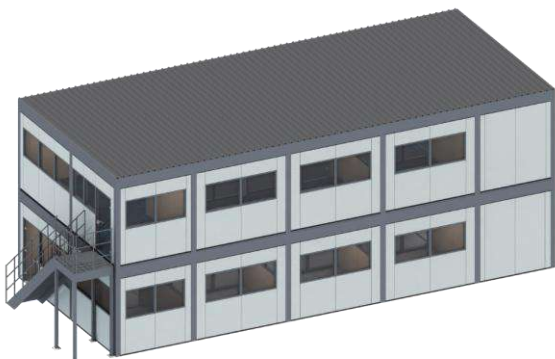

**MEZZ IN-PLANT OFFICE
with GROUND STORAGE**

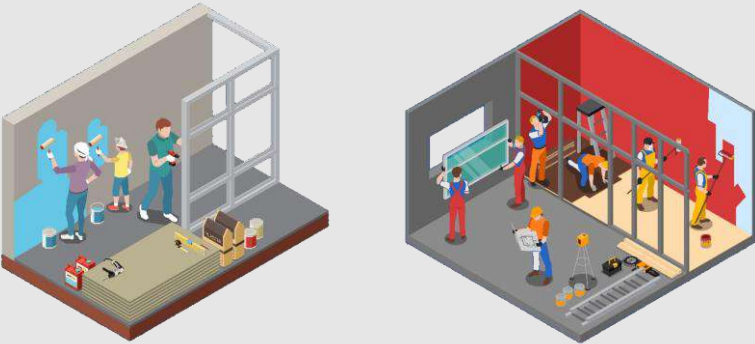

TWO STOREY IN-PLANT OFFICE

Why Choose Us?

CONVENTIONAL PROCESS	OUR PROCESS
<ul style="list-style-type: none"> × Messy Installation × Fixed and Permanent Structures × Time-Consuming Curing and Painting × No Scope for Customization Post-Completion × Unsustainable Design Approach × Maintenance Requires Damaging the Setup 	<ul style="list-style-type: none"> ✓ No Mess Installation ✓ Flexibility ✓ Speed of assembly ✓ Cost-effectiveness ✓ Customization ✓ Sustainable design ✓ Easy Maintenance
	

BENIFITS

- **Space Optimization:** Maximize vertical space, adding usable square footage without costly building expansions.
- **Ease of Assembly:** Pre-fabricated Structure for quick on site assembly.
- **Modularity & Upgradeability:** Enables easy expansion/reconfiguration due to modular design.
- **Cost Effective:** Saving on both construction and operational cost.
- **Utility Integration:** Ease of integrating utilities according to the requirement.

MATERIALS & BUILD QUALITY

Our office partitions are crafted from high-quality materials, ensuring durability and a professional appearance that will enhance any office setting.

- **Wooden Panels:** Prelaminated Panels
- **Glass Panels:** High Quality Sound Absorbing, Clear Toughened Glass framed in Aluminium Profiles
- **HDHMR boards:** (High Density High Moisture Resistance) Termite Resistant & Environment friendly for Washrooms
- **Metal Panels:** Powder coated, CRCA
- **Rockwool:** High-density Rockwool insulation ensuring superior performance and dual-layer protection
- High Quality Door Fittings
- Top Brand Fittings for Washrooms

APPLICATION

Factories and Warehouses.

INSTALLATION STEPS

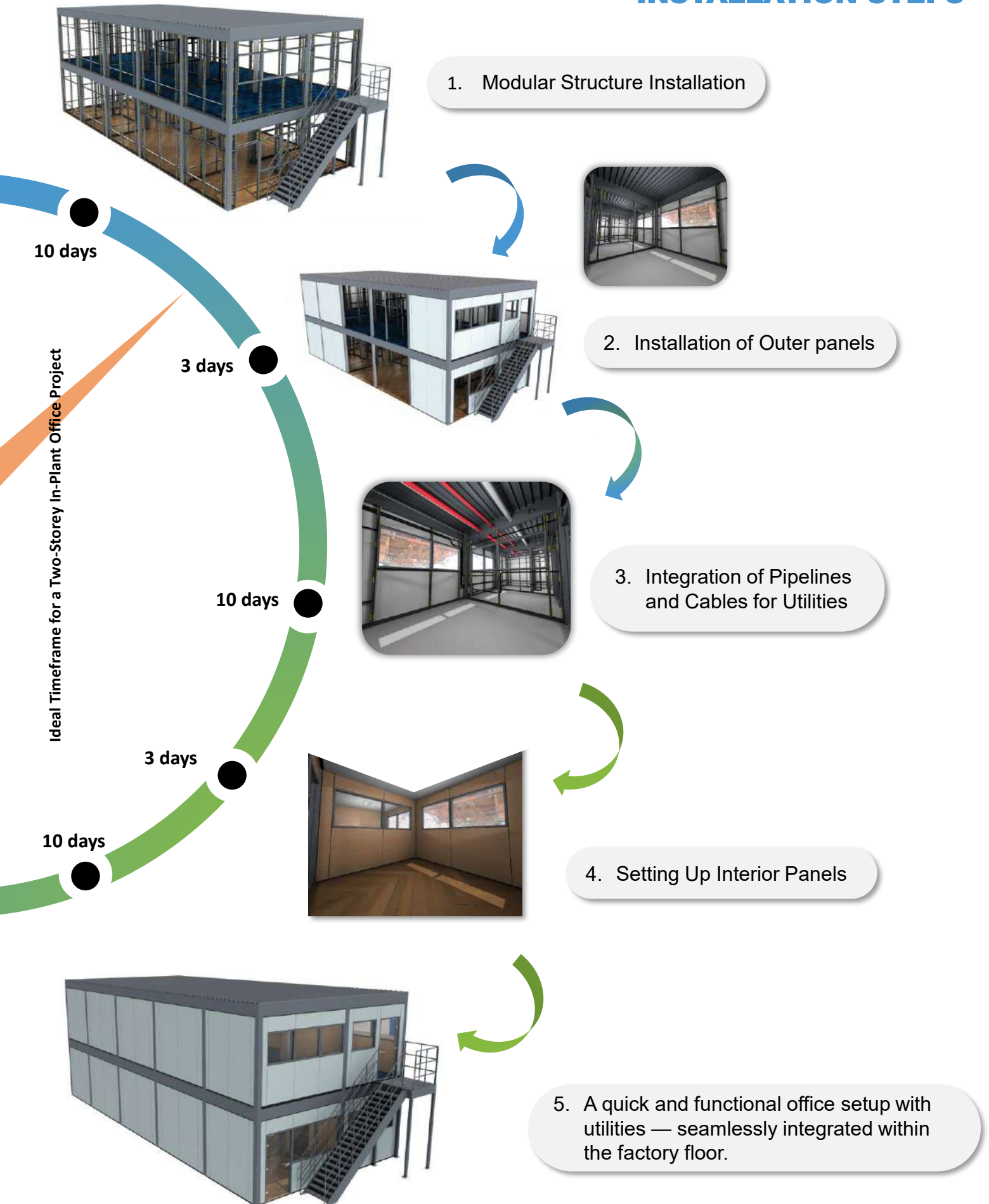

2000 sq. ft Project Handover Within 6 Weeks Time

WALL TYPES

ModulArt - PARTITION WALLS

AVAILABLE CONFIGURATIONS

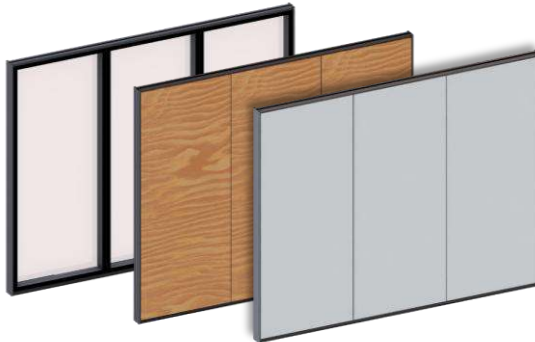

Full Panels



Half Panels

SPECIFICATIONS

MATERIALS & FINISH

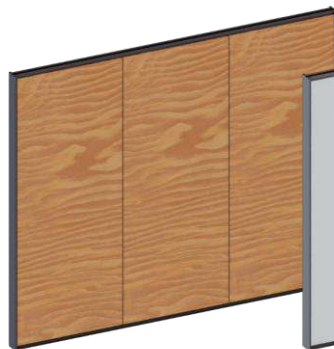

Wooden Panels



Metal Panels

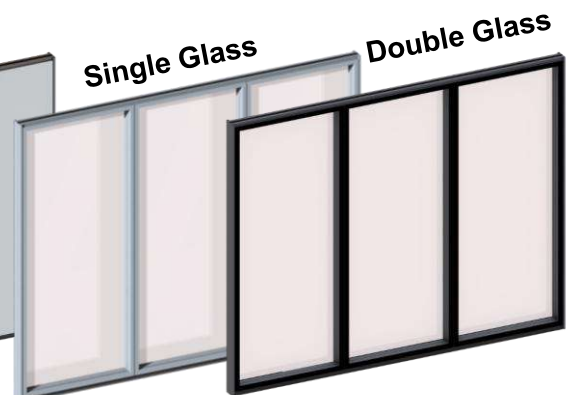

Glass Panels

*Sizes Available : 6mm thick
Toughened Glass*

DOORS

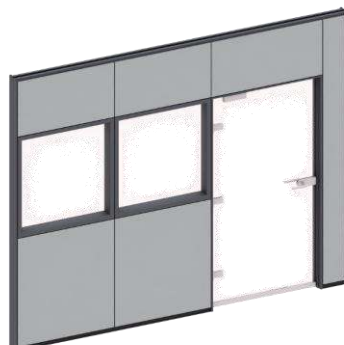

Door

Sizes Available: All Standard Door Sizes

**We provide Best
Quality Door
Hardware**

SECTION VIEW

Metal Panels

- Fire resistant
- Impact resistance

Wooden Panels

- Aesthetically Appealing

Single Glass Panels

- Allow Natural Light

Double Glass Panels

- Allow Natural Light
- Ideal for Soundproof Conference Rooms & Cabins

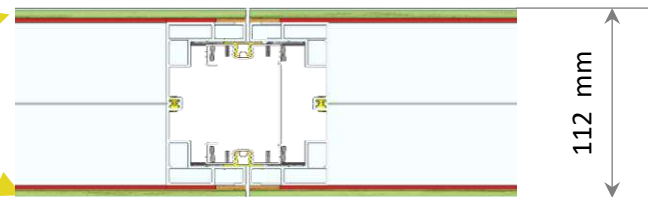
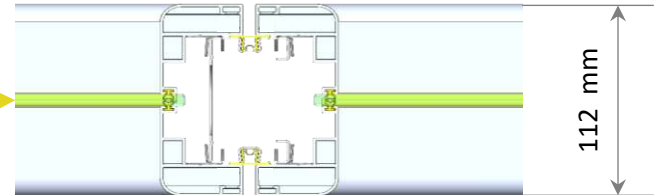
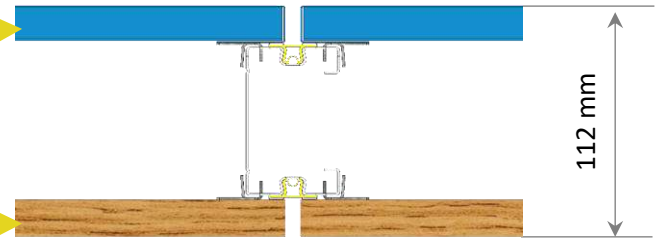

SOUND TRANSMISSION CLASS (STC) EVALUATION – Partition Walls

(as per ISO 10140-2 / ASTM E-90, evaluation index at 100-3150 Hz)

Double Pane Glass Wall: RW 44 dB

Single Pane Glass Wall: RW 26 dB

Steel Wall: RW 46 dB

Wood Wall: RW 48-49 dB



Half Glass Walls



Full Single Glass Walls



Full Double Glass Walls

FEATURES

LOAD BEARING WALL

Supports kitchen tops, shelves, cabinets, and workstations by securely accommodating accessories like shelf brackets.



Pantry Platform



Glass Shelves

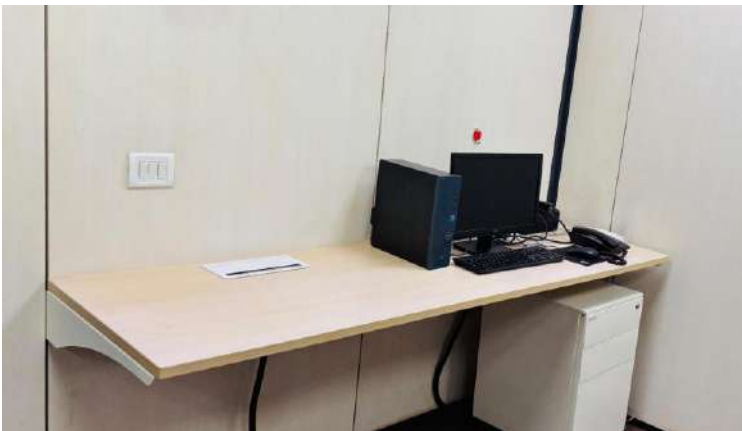

Work Stations

UTILITY-READY DESIGN

Supports seamless integration of ACs, sprinklers and smoke detectors



CONCEALED MEP SERVICES IN PARTITION WALL CAVITIES



Concealed AC Ducting And Drainage



Concealed Piping



Concealed Wiring

ATTACHED WASHROOMS



WALL DETAILS

Our partition walls are assembled using **precision-fitted gaskets** and **high-density Rockwool insulation** ensuring superior Sound performance in demanding environments and provides dual-layer protection from dust.

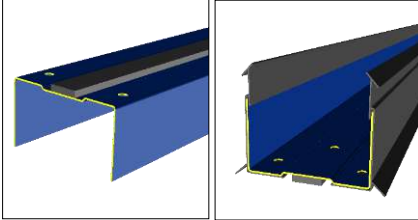

Top & Bottom Channels

- Gaskets at floor and ceiling connections
- Seals against dust & sound from top and bottom
- Also, compensates to Uneven flooring

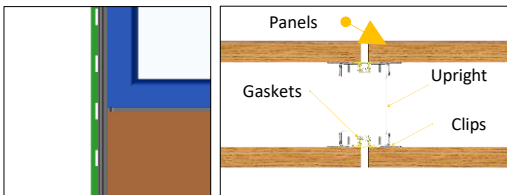

Vertical Supports

- Between panel edges - upright posts and Glass Frames
- Prevents air/sound leakage along vertical joints

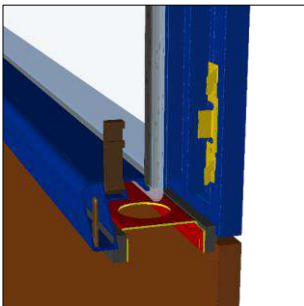

Horizontal Supports

- Gaskets sit between supports & panels
- Ensures tight horizontal grip and sound leakage

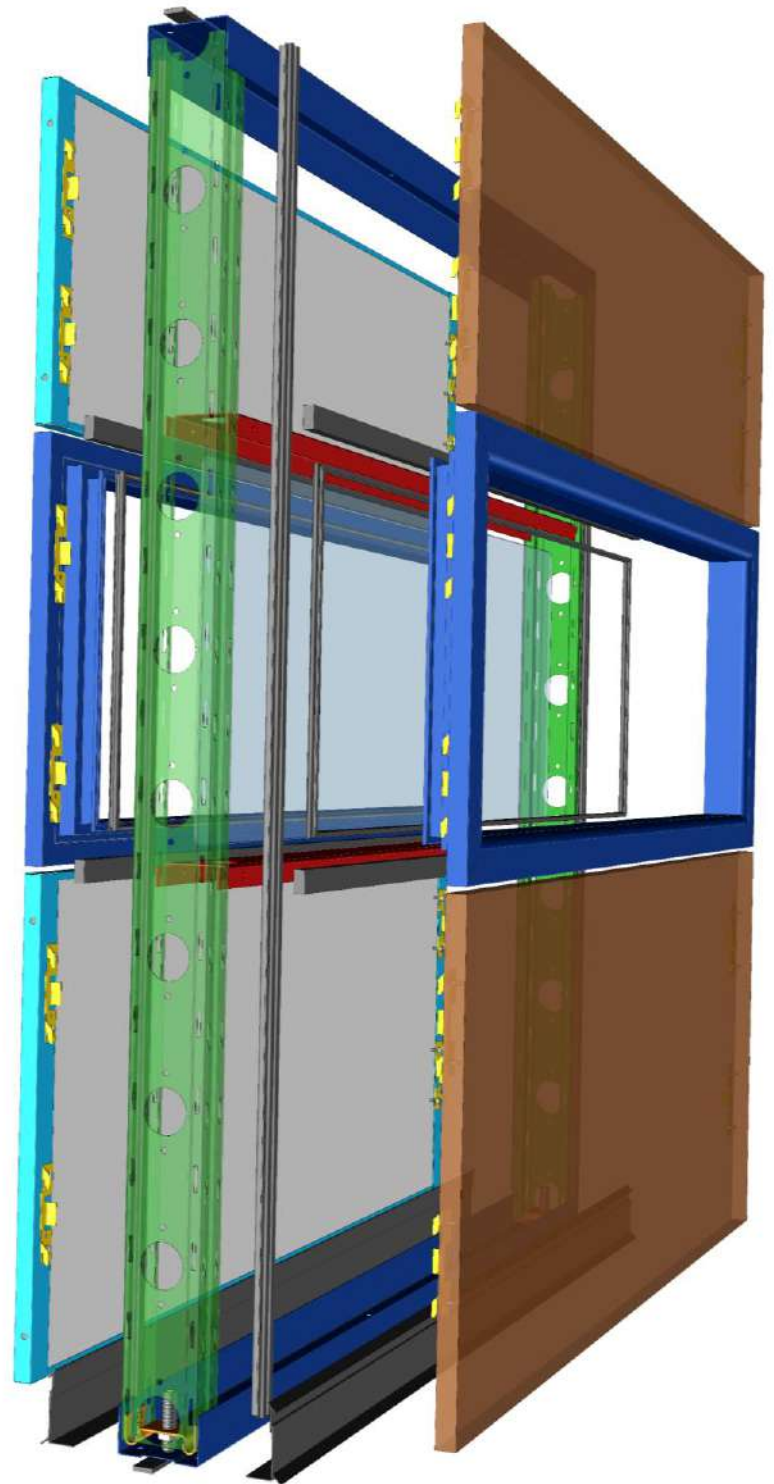

FULLY GASKETED ASSEMBLY

INTERIOR OF IN-PLANT OFFICE



Employees Work Space



Cabins



Lobby Area



Conference Room



Motorized Venetian blinds seamlessly integrated into a Double Glass Frame.

KEY PROJECTS



Esmech, Wada In-plant Office for technical staff & Management Team

ENCLOSURES



Ford Motors, Chennai Enclosure for Blanking Line designed with structure and roofing



Ronch Polymer, Pune In-plant enclosure



MEPL, Kopar khairne In-plant Office for technical staff & Management Team

SELECTION GUIDE

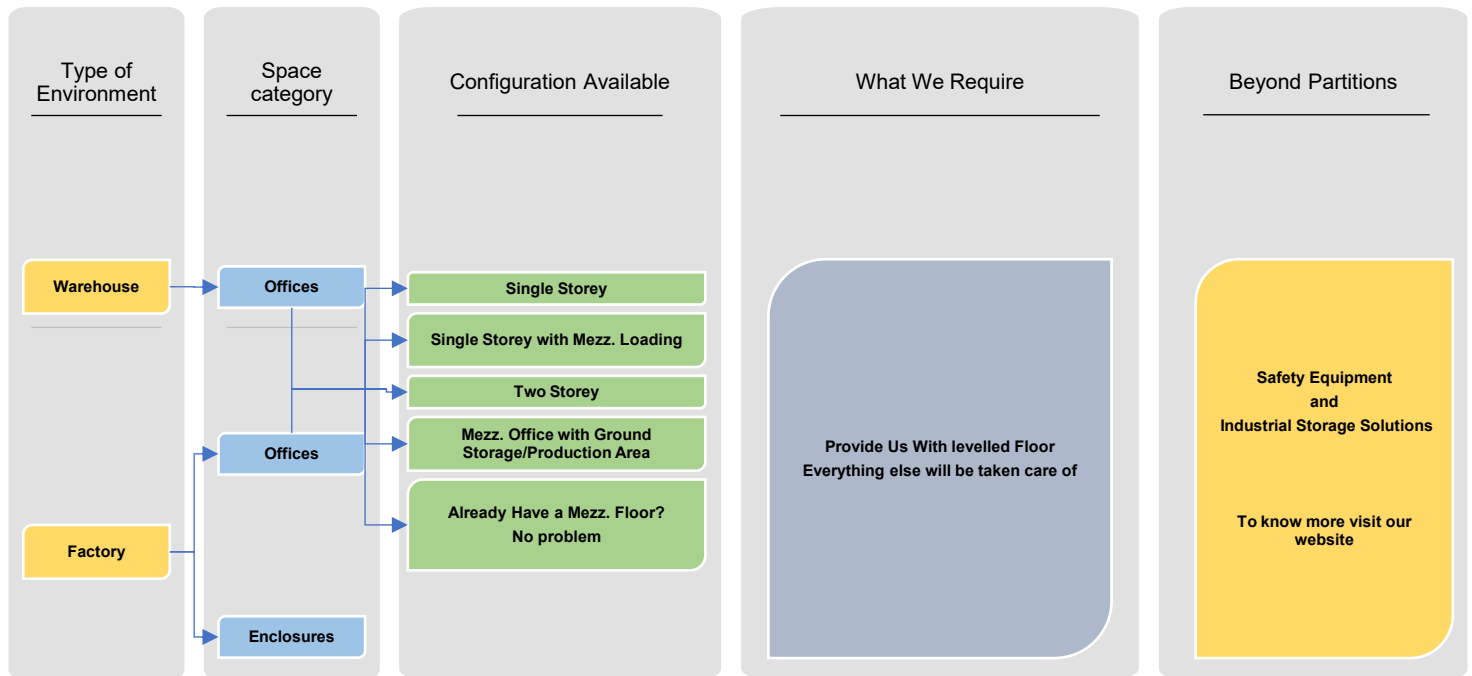

GUIDANCE IN SELECTING BUILDING SYSTEMS

We offer assistance in selecting the right **HVAC SYSTEMS, WORKSTATIONS, FIREFIGHTING SOLUTIONS & FALSE CEILINGS** for your space. Our experts work closely with you to understand your specific needs and preferences, ensuring that every choice enhances both the functionality and safety of your environment. With our support, you can confidently make decisions that align with your goals and optimize the performance of your workspace.

VERSATILITY

Our **ModulArt** In-plant Office is highly versatile for accommodating every possible conceivable office inputs such as: AC Grills & Ducting, Firefighting System, Venetian Blinds, Shelving, Desking and Storage.

OTHER PRODUCTS



INDUSTRIAL STORAGE SOLUTIONS



WAREHOUSE SAFETY EQUIPMENT



MODULAR OFFICE PARTITIONS



OFFICE FURNITURE

OUR CLIENTS





CORPORATE OFFICE

1 Ground & Mezz. Floor, Lakhi
Industry House, LBS Marg,
Bhandup (W), Mumbai -
400078

FACTORY

Plot No. A-805/1, Sector 2,
TTC Industrial Area, Kopar
Khairane MIDC, Navi-
Mumbai - 400710

Email: sales@manikindia.com

Contact: +91 84240 40899

www.manikindia.com



 https://www.youtube.com/@MEPL_India



 <https://in.linkedin.com/company/manik-engineering-pvt-ltd>